

CERTIFIED RECORD OF LAND CORNER MONUMENTATION

History of original corner establishment:

Original survey by Henry Gradon in 1884 under GLO Contract No. 499. Set a post 3 ft. long, 3 ins. square 24 ins. in ground for 1/4 sec. cor. marked 1/4 S on W face.

From Which:

A Fir 7 ins. dia. bears N72°W 18 lks. dist. marked 1/4 S BT.

A Fir 10 ins. dia. bears S85°E 14 lks. dist. marked 1/4 S BT.

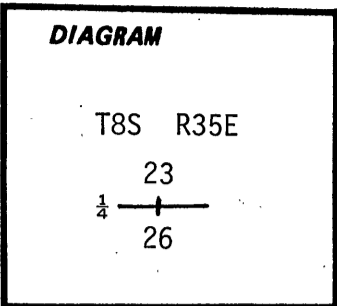

Description of corner evidence found:

A Douglas Fir 20" dia. with axed open blaze and visible scribing "S" bears S85°E 9.2 ft. A Fir stump 20" dia. has a BT tag and bears N66°W 15 ft., which does not agree with record. The stump has no markings.

At record bearing and dist. (N72°W 11.9 ft) we find no evidence of NW BT.

Description of monument and accessories I established to perpetuate the original location of this corner:

At record bearing and dist. from original SE BT, we set a 2 1/2"x30" galvanized iron pipe 16" in ground to bed rock with mound of stone and dirt to top with brass cap attached, stamped:

T8S R35E

23

1/4 ————

26

1982

OR PLS 1099

From Which:
Original BT

A 20" Douglas Fir alive and in good condition bears S85°E 9.2 ft. with visible scribing.

New BT's

A White Fir 14" dia. bears N64°W 90.1 ft., scribed 1/4 S23 BT.

Attached brass washers stamped LS 1099 to foot blaze of new BT.

Corner position monument and perpetuated in accordance with Umatilla Forest Cadastral Survey, Contract No. 53-04R3-2-0127.

Staff Compass (Declination 18°E)
Steel Tape.

Witnesses: Glen D. Wagoner
Greg Orton
Jeff Anderson

Nov. 2, 1982

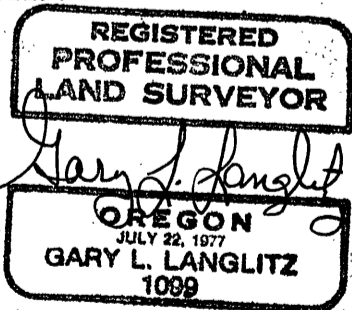

Office of Surveyor County of Grant

State of Oregon, I hereby certify that the within instrument was filed in this office for record on the 2 day of Feb, 1982

Robert D. Baggett by _____

(COUNTY OFFICIAL) (DEPUTY)